

Vehicle Site Access

NOTE : Beyond red-line boundary the design and construction of access road, pavement and grass verge by others

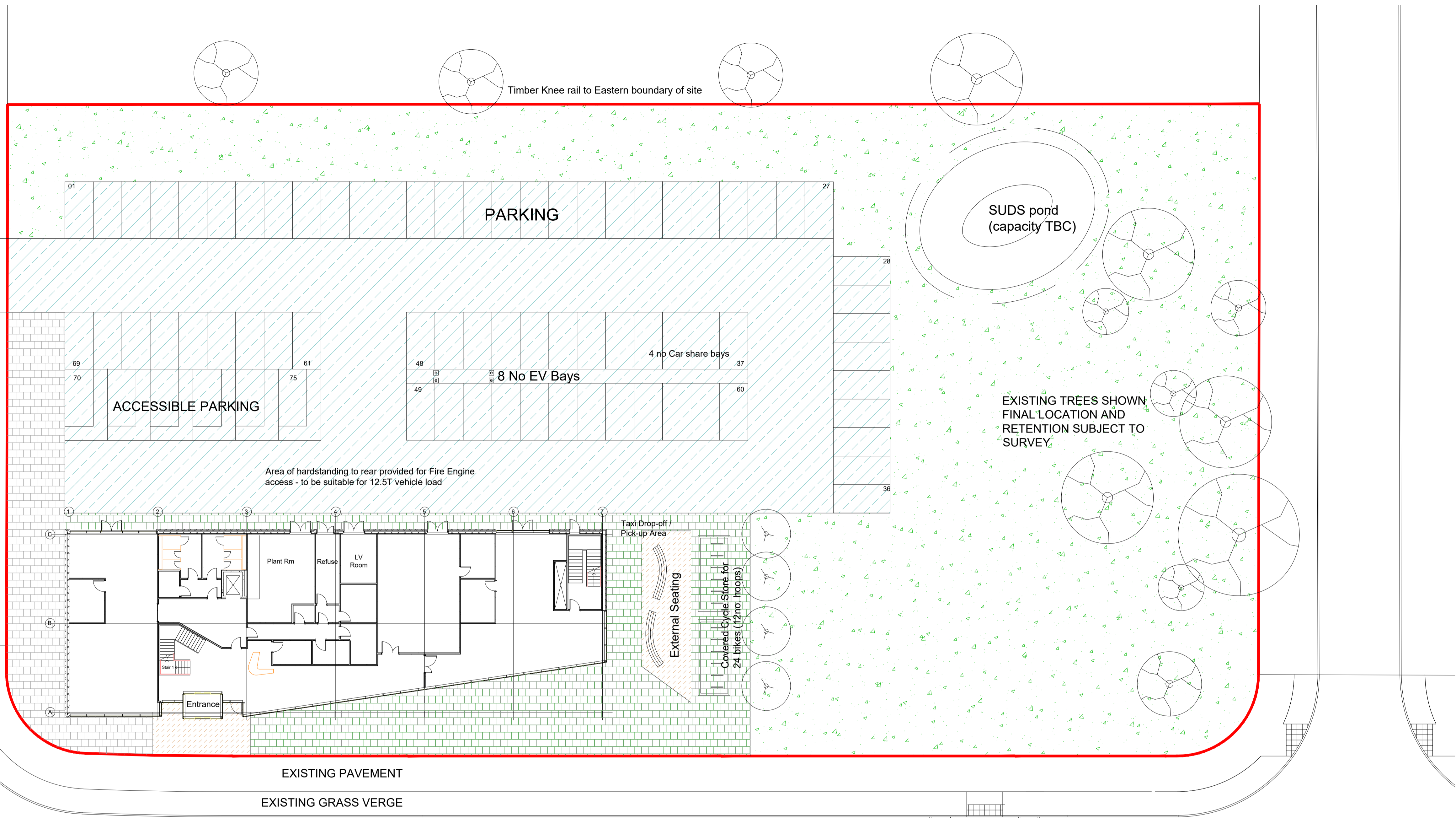

JOHN WILLIAMS BOULEVARD

EXISTING PEDESTRIAN CROSSING

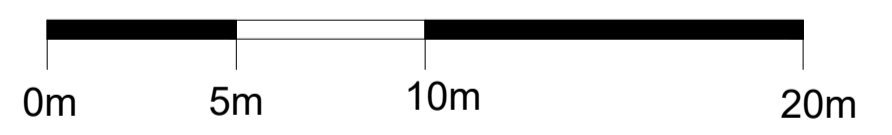

Tarmac (to parking areas) 1942sqm

Paving Type 1 (Standard) 618 sqm

Paving Type 2 (Feature) 100sqm

Grass 2318sqm

SITE AREA (within red-line boundary) = 5775 sqm

Refer to Civil Engineers drawings and specification for substructure build ups of external paving areas, kerbs, and external drainage.

Refer to service engineers drawings for external lighting, services runs.

P9	JC	TR	20.5.20	SUDS Pond shown	P10	JC	TR	11.6.20	Parking extended to 75 spaces, substation relocated SUDS & cycle store relocated
P8	JC	TR	15.5.20	External works and landscape reconfigured - Parking area relocated and spaces reduced to 50no. Site access relocated. existing trees retained where shown.					
P7	JC	TR	15.5.20	STAGE 3 ISSUE					
P6	JC	TR	17.4.20	Cycle store note added					
P5	JC	TR	15.4.20	Red line extended to pavement line; Building footprint relocated west; Fire engine access added, areas of paving and car-park realigned					
P4	JC	TR	31.3.20	Correct Drawing number annotation added					
P3	JC	TR	31.3.20	Parking layout reconfigured to accommodate refuse vehicle tracking, 20 cycle spaces indicated, 8no EV bays shown					
P2	JT	TR	27.3.20	Suds omitted, Substation added, EV added, surface treatment added					
P1	JT	TR	11.3.20	Pre-app Planning Submission					
Rev	C	R	Date	AMENDMENT					

Notes: OS Licence No: 100006354. All dimensions to be checked on site. DO NOT SCALE FROM DRAWING. Discrepancies ambiguities and/or omissions between this drawing and information given elsewhere must be reported immediately to the architect before proceeding. THIS DRAWING IS COPYRIGHT. This drawing is to be read in conjunction with drawings:-

NAPPER

info@napperarchitects.co.uk www.napperarchitects.co.uk

Napper Architects Ltd
3 Waterloo Square
Newcastle upon Tyne
NE1 4DR
Tel: 0191 2610491

First Floor, 6 Bakers Yard
London
EC1R 3DD
Tel: 0203 9066814

Project:	DARLINGTON HYBRID INNOVATION CENTRE		
Client:	DARLINGTON BOROUGH COUNCIL / WILMOTT DIXON		
Drawing:	Site Plan	Job Number:	201008
Scale:	1:200 at A1.	Date:	May 2020
Drawing No.:	HIC-NAP-20-00-DR-A-80002	Drawn:	TR
Rev:		Rev:	P10